



Color: White

Weight: 1.3 lbs

<b>Project:</b>	<b>Type:</b>
<b>Prepared By:</b>	<b>Date:</b>

Driver Info		LED Info	
Type	Constant Current	Watts	16/12/9W
120V	.13A	Color	3000/3500/4000/5000K
208V	.08A	Temp	
240V	.07A	Color Accuracy	90 CRI
277V	.06A	L70	N/A
Input Watts	16/12/9W	Lifespan	
		Lumens	900 lm
		Efficacy	100

## Technical Specifications

### Performance

#### Product Type:

Commercial Downlight

#### Description:

Wattage and CCT selectable commercial downlights for new construction and retrofit applications.

#### Wattage Equivalency:

32/18/16W CFL

#### Input Wattage:

16/12/9W

#### Lumens:

16W: 3000K @ 1,578lm; 3500K @ 1,658lm; 4000K @ 1,677lm; 5000K @ 1,636lm

12W: 3000K @ 1,128lm; 3500K @ 1,170lm; 4000K @ 1,180lm; 5000K @ 1,167lm

9W: 3000K @ 872lm; 3500K @ 900lm; 4000K @ 907lm; 5000K @ 904lm

#### Efficacy:

16W: 3000K @ 101lm/W; 3500K @ 106lm/W; 4000K @ 108lm/W; 5000K @ 105lm/W

12W: 3000K @ 105lm/W; 3500K @ 109lm/W; 4000K @ 111lm/W; 5000K @ 109lm/W

9W: 3000K @ 105lm/W; 3500K @ 109lm/W; 4000K @ 110lm/W; 5000K @ 110lm/W

#### L70 Lifespan:

50,000-Hour LED lifespan based on IES LM-70 results

### Electrical

#### Driver:

Constant Current, Class 2, 60 Hz, 120V-277V, 120V: 0.13A, 208V: 0.08A, 240V: 0.07A, 277V: 0.06A

#### Dimming Driver:

Driver includes dimming control wiring for 0-10V dimming systems. Requires separate 0-10V DC dimming circuit. Dims down to 10%.

#### THD:

≤20%

#### Power Factor:

≥0.9

#### Dimmable:

Yes, 0-10V dims down to 10%. See Dimmer Compatibility List.

#### Input Voltage:

120-277V

#### Operating Frequency:

50/60Hz

#### Input Current @ 240V (mA):

65mA

#### Input Current @ 277V (mA):

60mA

#### Operating Temperature:

-4°F to 104°F (-20°C to 40°C)

#### Flicker:

≤30%

#### Color Temperature:

Field Adjustable via dip switch  
3000/3500/4000/5000K

### LED Characteristics

#### Color Accuracy (CRI):

>90 CRI

#### R9 Value:

High color performance with R9 greater than or equal to 50

#### Color Consistency:

4-step MacAdam Ellipse binning to achieve consistent fixture-to-fixture color

**Technical Specifications (continued)****Color Stability:**

LED color temperature is warranted to Shift no more than 200K in color temperature over a 5-year period

**Color Uniformity:**

RAB's range of Correlated Color Temperature follows the guidelines of the American National Standard for Specifications for the Chromaticity of Solid State Lighting (SSL) Products, ANSI C78.377-2017.

**Installation****Mounting:**

Recessed

**Construction****Size:**

6"

**Shape:**

Round

**Finish:**

White

**Enclosure Material:**

Metal

**Trim Style:**

Smooth

**Lens:**

Polycarbonate light diffuser distributes light evenly and smoothly for general lighting applications

**Cut Out Template Size:**

6 5/16"

**Compliance****Listings:**

UL Listed, UL Classified

**Environment:**

Suitable for use in dry, damp, and wet environments.

**IC Rated:**

Suitable for direct contact with insulation

**Air Tight:**

Housing certified Air Tight as per ASTM-E283

**Energy Star Approved:**

This product is ENERGY STAR® Version 2.2 Certified.

**Certification Model Number:**

DLC1001(CRLEDFA-6R-16S-9CCT-UNV-WS)

**T20 Compliant:**

Not compliant

**California Title 24 JA8 Compliant:**

Can be used to conform with the requirements of California Title 24 Part 6.

**California Energy Commission (CEC) Status:**

Lawful for Sales in California

**NEC Compliant:**

Suitable for use in closets. Compliant with NEC Sec. 410.16 (A)(1) and 410.16 (C3).

**IESNA LM-79 & LM-80 Testing:**

RAB LED luminaires and LED components have been tested by an independent laboratory in accordance with IESNA LM-79 and LM-80.

**RoHS:**

Mercury and UV free. RoHS-compliant components.

**FCC:**

Complies with Part 15 of the FCC Rules

**Trade Agreements Act Compliant:**

This product is a product of Cambodia and a "designated country" end product that complies with the Trade Agreements Act

**Energy Star ID:**

3624369

**Other****Accessories:**

[DLPLATE/C3468R/NB](#)

[DLPLATE/WFR3468/NB](#)

Mounting Plate w/nailer bar

[DL6-8GOOF/R/P/CRLEDFA](#)

Commercial Downlight 6"-8" Goof Ring

[DLTRIM/CRLEDFA6R-BNS](#)

6" Smooth Brushed Nickel Color Trim

[DLTRIM/CRLEDFA6R-BRS](#)

6" Smooth Bronze Color Trim

[DLTRIM/CRLEDFA6R-BS](#)

6" Smooth Black Color Trim

[DRI-25-EMGR-DC](#)

Emergency Back up Driver

[DRI-21-EMGR-DC-D10](#)

Emergency backup driver

**5-Year, No-Compromise Warranty:**

RAB warrants that our LED products will be free from defects in materials and workmanship for a period of five (5) years from the date of delivery to the end user, including coverage of light output, color stability, driver performance and fixture finish. RAB's warranty is subject to all terms and conditions found at [rablighting.com/warranty](http://rablighting.com/warranty).

## Dimensions

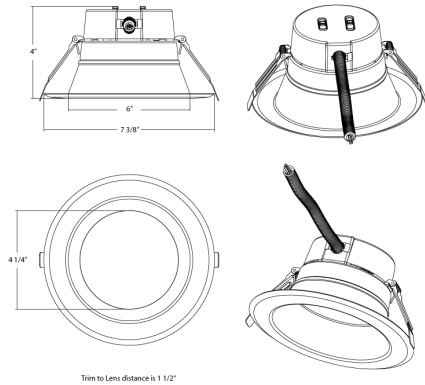

## Features

- Mounts directly into ceiling, no housing required
- Field-adjustable "set and forget" color temperature
- High-performance LEDs for commercial applications
- Meets air-tight requirements
- 0-10V dimming, see Dimmer Compatibility List
- Suitable for wet and damp locations
- Replacement for traditional compact fluorescent recessed downlights

## Ordering Matrix

Family	Size	Shape	Wattage	CRI/Color Temp	Driver	Finish	Trim	Battery Backup
CRLEDFA	6	R	16S	9CCT	UNV	W	S	
	6 = 6" 8 = 8" 10 = 10" 4 = 4"	R = Round	24S = 24/19/15W Adjustable 43S = 43/37/32W Adjustable 33S = 33/29/25W Adjustable 22S = 22/16/11W Adjustable 16S = 16/12/9W Adjustable 12S = 12/9/7W Adjustable	9CCT = 90 CRI, 3000/3500/4000/5000K CCT Adjustable	UNV = 120-277V, 0-10V Dimming	W = White	S = Smooth	Blank = No Battery Backup /E = Battery Backup